

# PREDOR



## Access Control and Time Attendance System



**1000+**  
systems

**200 000+**  
users

**10+ years**  
experience

# PREDICOR

Access control, time & attendance system



# Why Predor?

## STAND OUT FROM THE CROWD

Be unique! In today's globalized market, more and more companies offer the same off-the-shelf products. Differentiation disappears, leaving only price competition.



### STRATEGIC PARTNERSHIP

Predor systems are distributed by only one or at most two partners per country. This ensures that investments in marketing, training and market development truly pay off for our partners.



### PREMIUM SERVICES

We support our partners with training, online technical assistance, marketing support and extensive integration capabilities. Don't just sell a product — offer a powerful, premium solution.



### INTEGRATION AND CUSTOMIZATION

We provide a comprehensive API for system integrations, enabling seamless connectivity with virtually any third-party solution. The system can be tailored to meet specific operational needs.



### COMPLETE CONTROL

Monitor and manage all security-related events from a single software interface. Access control, time attendance, video surveillance, vehicle access and alarm handling can all be supervised from one platform — even directly from your mobile phone.



### 10+ YEARS OF EXPERIENCE

In Hungary, we have been working with a single exclusive distributor for more than 10 years. More than 1,000 active systems are in operation, serving over 200,000 users.



### PROFESSIONAL TIME ATTENDANCE

The Predor time & attendance system is designed for large enterprises, meets even the most complex operational requirements. Any work schedule can be easily configured.



### HIGH SECURITY STANDARDS

The Predor system delivers exceptionally high security. The system meets EN 60839-11-1 Grade 4 level, which represents the highest level of security designed to protect military facilities or critical infrastructure.

# Tailored Solutions

In addition to large enterprises employing thousands of people, we also offer cost-effective solutions for small businesses.



Manufacturing plants



Corporate headquarters



High-security facilities



Small and medium-sized businesses



Office buildings



Educational institutions



Construction projects



Logistics centers

# Enterprise Access Control System



## Integrated System

All events generated by installed security systems can be monitored through a single software interface. The system can manage multiple sites or even multiple companies within one platform.

## Evacuation and Disaster Management

In the event of a fire, the system automatically generates a photo-based evacuation list. Using the mobile application, it becomes much easier to identify who may still be inside the building.

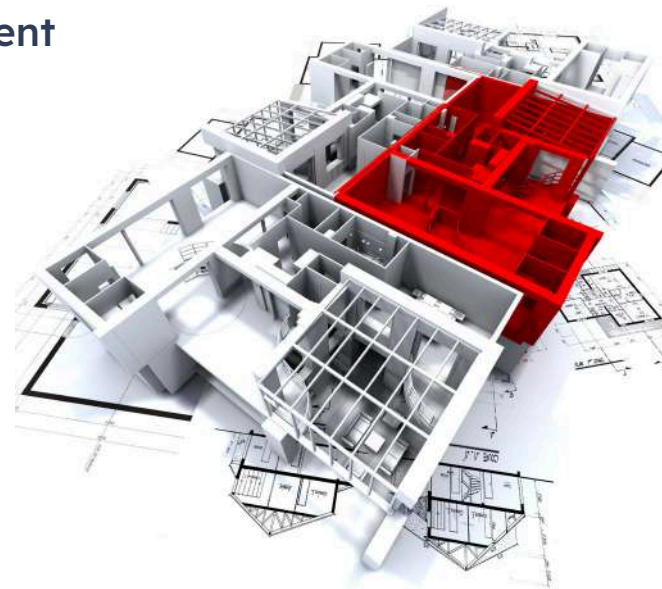

## Emergency Lockdown

High-security facilities or schools can automatically lock down specific areas in case of an incident.

## Mobile Application

Our free mobile application enables you to monitor company security and employee activity anytime and from anywhere.

### Main features:

- view alerts
- manage evacuation lists
- check employee locations
- disable users with one action
- remotely open or close doors

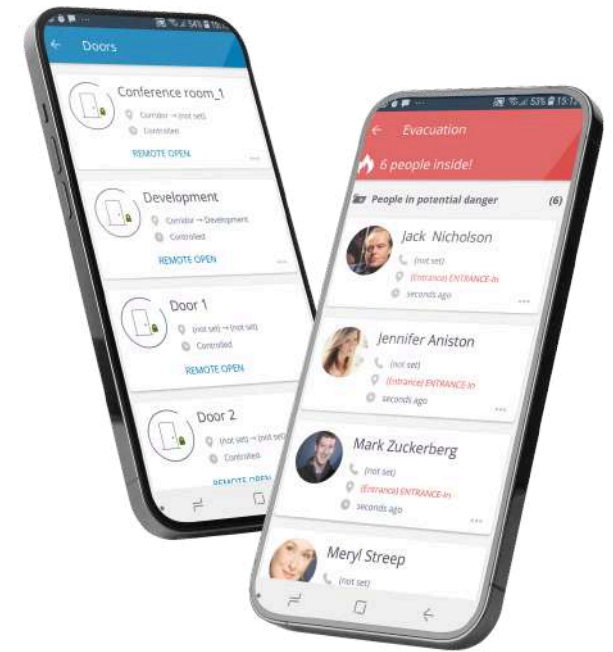

## QR Code as an access credential

The system generates a unique QR code, which can be sent via email or printed instantly using a preconfigured printer. This allows the automation of access control and can replace reception personnel. This is an ideal solution for office buildings or event venues for managing visitors.



# Security Is Not a Cost – It Is an Investment

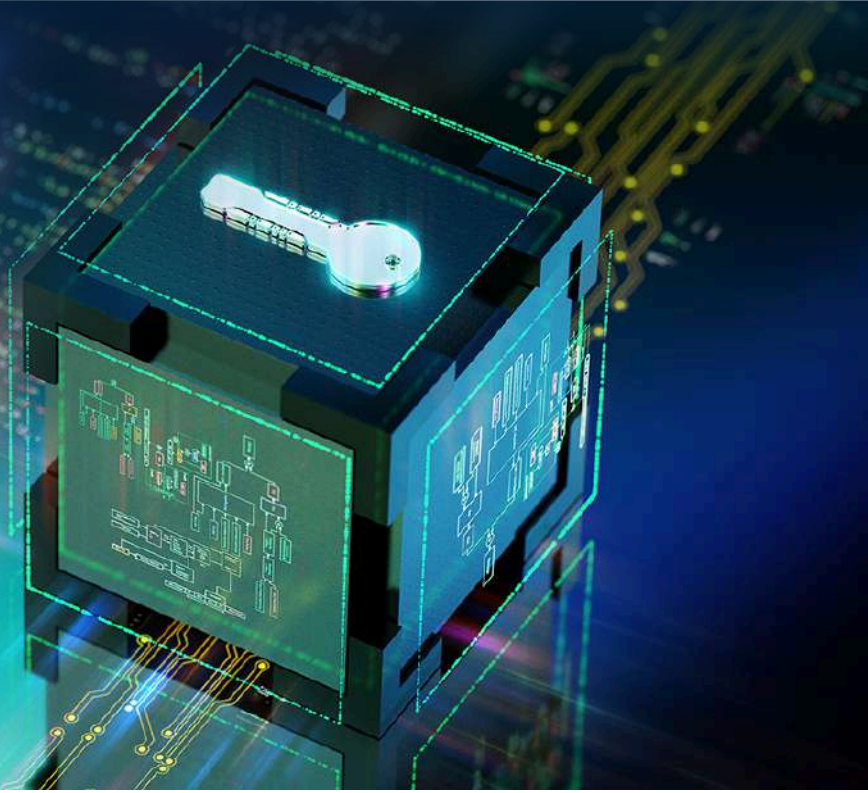

## Did you know?

Most identification cards currently in use can be copied within seconds using simple and inexpensive devices.

## GRADE 4 certified

We are proud that the Predor access control system has achieved GRADE 4 certification, the highest level of security classification. Achieving this required partnering with a technology leader at the forefront of encryption.

We are among the first in Europe to implement deep integration with STid readers, a leading brand in secure identification technologies. Through STid's SSCP (Smart & Secure Communication Protocol), the entire communication path is secured with end-to-end AES-128 encryption.

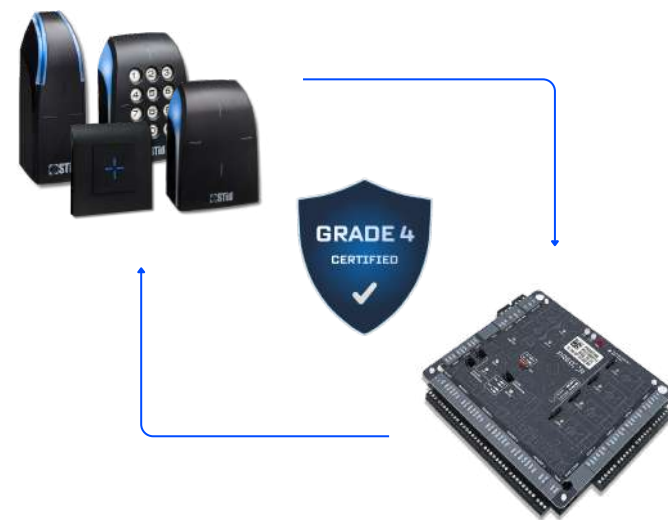

## Integrated STid Reader Family Encryption

The most advanced encryption algorithms ensure end-to-end data protection (AES-128, SHA-256). Outdoor models are resistant to extreme environmental conditions. Vandal-resistant models have IK10 impact protection certification. Certain models can be expanded with fingerprint readers and QR code readers.



## Adapted to Your Needs

A wide range of color options is available, and custom designs can also be ordered. LED feedback indicators can also be customized. When used with the Predor system, card readers can also function as time-attendance registration points.



## Alarm Management

When an alarm occurs, the camera image monitoring the affected access point appears automatically. The exact location of the alarm is also displayed on a map, allowing security personnel to respond more efficiently.



## Video recording and tracking

Each card scan can automatically trigger photo or video recording. This allows quick retrieval of recordings and helps prevent misuse of access cards.

The selected person can be continuously monitored in a separate window. The system always displays the image of the area where the person is currently located.



## Vehicle Access and License Plate Recognition

All vehicle-related events can be monitored from a single software interface. Predor integrates with the most commonly installed license plate recognition systems (Hikvision, Dahua). This enables automated barrier control and traffic logging. Events can be easily searched by license plate, driver, timestamp or other identifiers



## GDPR Compliance

Predor can automatically review stored data on a daily basis and perform automated data management tasks according to configured rules.



## Mobile ID

With STid Mobile ID, a smartphone becomes a fully functional access credential. The digital identifier communicates with the reader over an encrypted channel using NFC or BLE, ensuring secure, fast and contactless entry. No more lost cards, credentials can be remotely activated or revoked.

## Biometric Identification

The Predor system supports a wide range of biometric devices, including fingerprint readers, facial recognition systems or other biometric identification solutions.

However, biometric devices are not automatically more secure, so consulting a specialist before choosing is recommended.



## Guard Tour Management

Custom patrol routes can be created using the access control readers. Security guards can use their own access cards, eliminating the need for expensive data collection devices. Detailed reports are generated for all patrol activities.

# Time & Attendance

## Increase efficiency with Predor

With the Predor system, you can reduce administrative burdens and monitor employee efficiency.



### SCHEDULING MODULE

The system automatically flags schedules that deviate from the optimal, ensuring maximum productivity without tying up unnecessary resources.



### SIMPLE LISTING OF IRREGULARITIES

You can set the system to email the previous day's list of late arrivals to the department manager.



### REPORTS AVAILABLE WITH ONE CLICK

Save detailed reports summarizing overtime and work time balances so that you can generate reports with one click.



### AUTOMATIC SHIFT RECOGNITION

There is no need to define the shift schedule in advance. The system assigns employees to shifts based on movement data using an automatic matching algorithm.



### SCHEDULABLE AUTOMATED REPORTS

This allows the system to generate data for payroll software without intervention, or automatically generate PDF attendance sheets.



### PREVENT MISUSE

You can view camera images and videos of card swipes filtered by person and time interval to prevent misuse.



### TEMPORARY CARDS

If an employee has forgotten their ID card at home, a temporary card can be issued in a few seconds to ensure that the work time data for that day remain accurate.



### EASILY OVERCOME EMPLOYEE NEGLIGENCE

In the event of an absent departure, you can set the system to only count working time up to a certain point in time. Any work time data can be manually modified afterwards, if necessary.

## Office work time terminal

With a built-in RGB LED strip, clean design, Wi-Fi communication capability it is the perfect choice for offices and office buildings. The device also has a built-in 125kHz and 13.56MHz card reader, so it can be flexibly integrated into your existing office environment. In many cases customers can keep using their current RFID cards.



## Work time calculation

Working time is basically calculated based on movement data. Employees register activities at checkpoints with their access cards, biometric or other unique identifiers, allowing the system to track how much time employees spent in each workspace and what activities they performed there.

For proper work time recording, activity codes must be used to determine whether a given activity counts as working time and whether it is paid. Activity codes (arrival, departure, break, etc.) can be registered with card readers or touchscreen work time terminals with built-in card readers located at passageways.

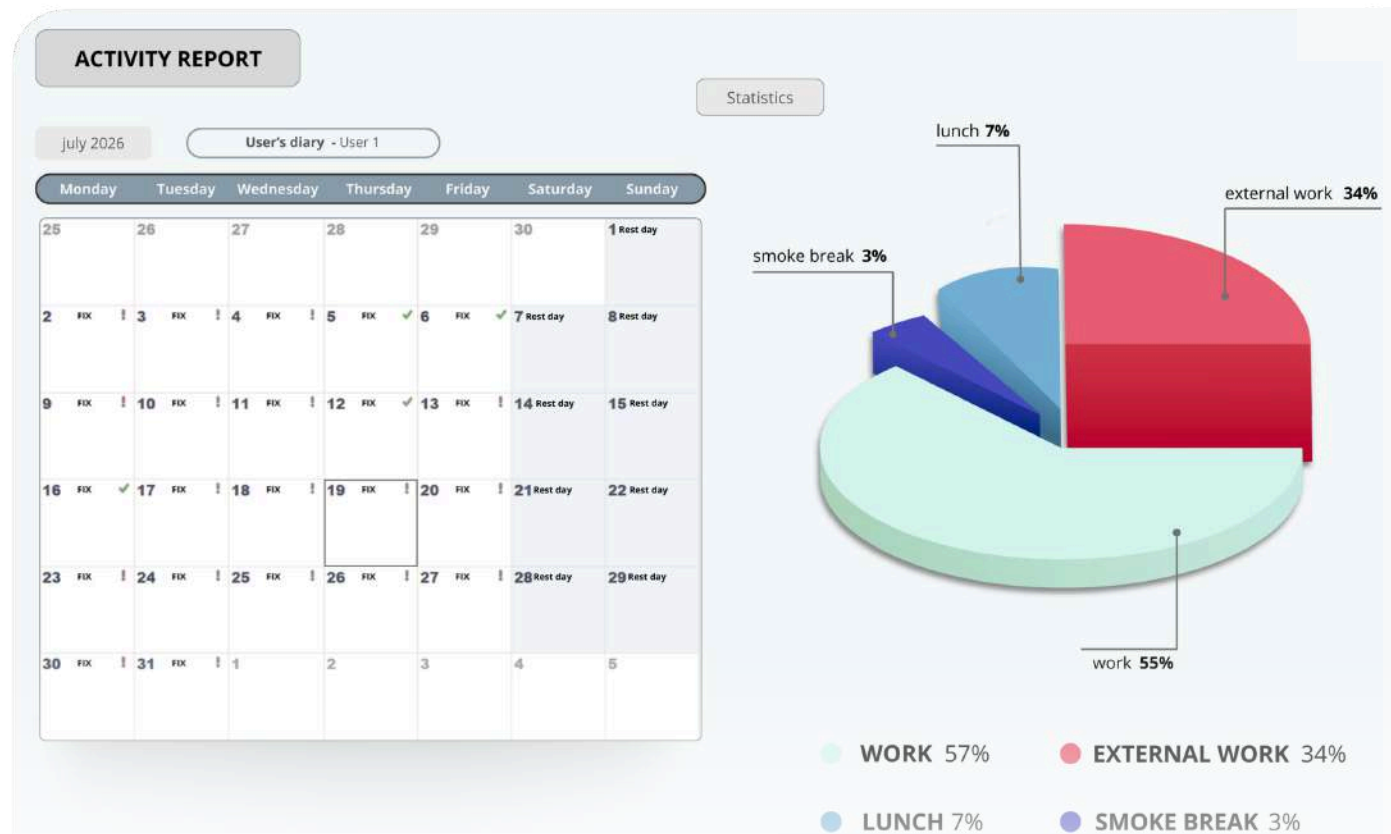



## Scheduling Module

The system automatically flags schedules that deviate from the optimal, ensuring maximum productivity without tying up unnecessary resources. It also ensures legal compliance according to your company's needs.

### Get the most out of your company

If fewer than the minimum number of employees are scheduled, the system lists the people who can still be assigned while taking current legislation into account. Employees can be assigned to shifts with just a few clicks, and any changes can be handled quickly, so operations remain uninterrupted.



### Streamlined interface

Managers can quickly decide which shifts need to be changed or optimized from the monthly and weekly reports by a glance.

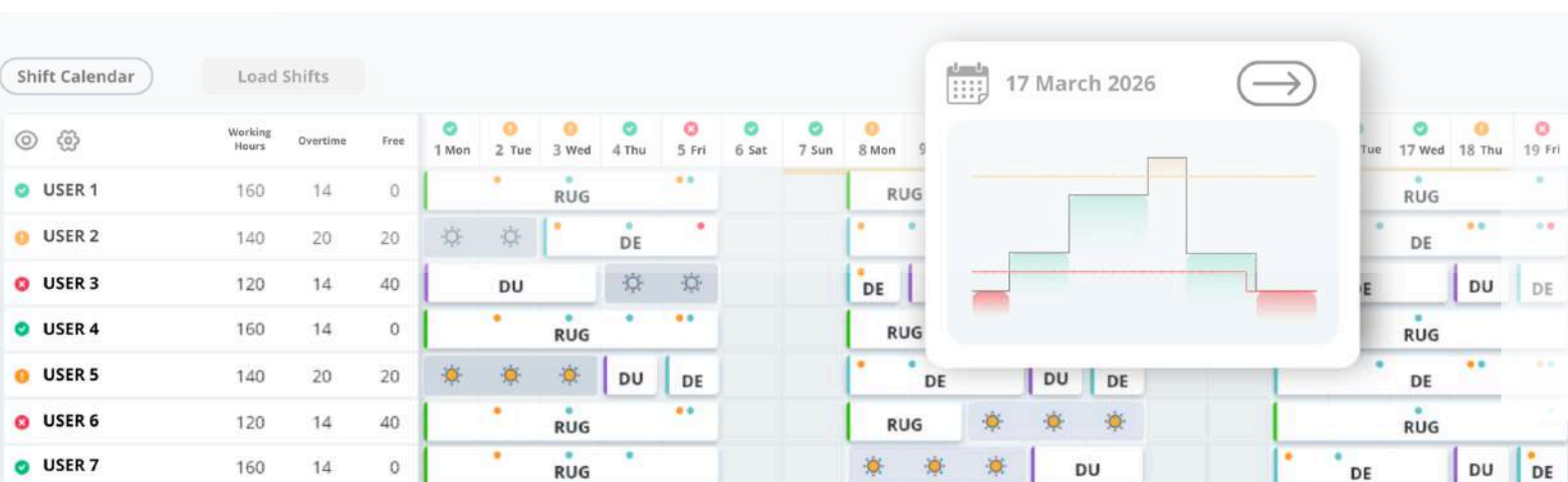

## Work time reports

### Users' monthly activities

This is an overview report in which every element (cell, header, and column) functions as a link. By clicking on a cell, the daily report for that particular day and person appears, on which the activities can be edited. The list view can be filtered for irregularities and work time violations too.

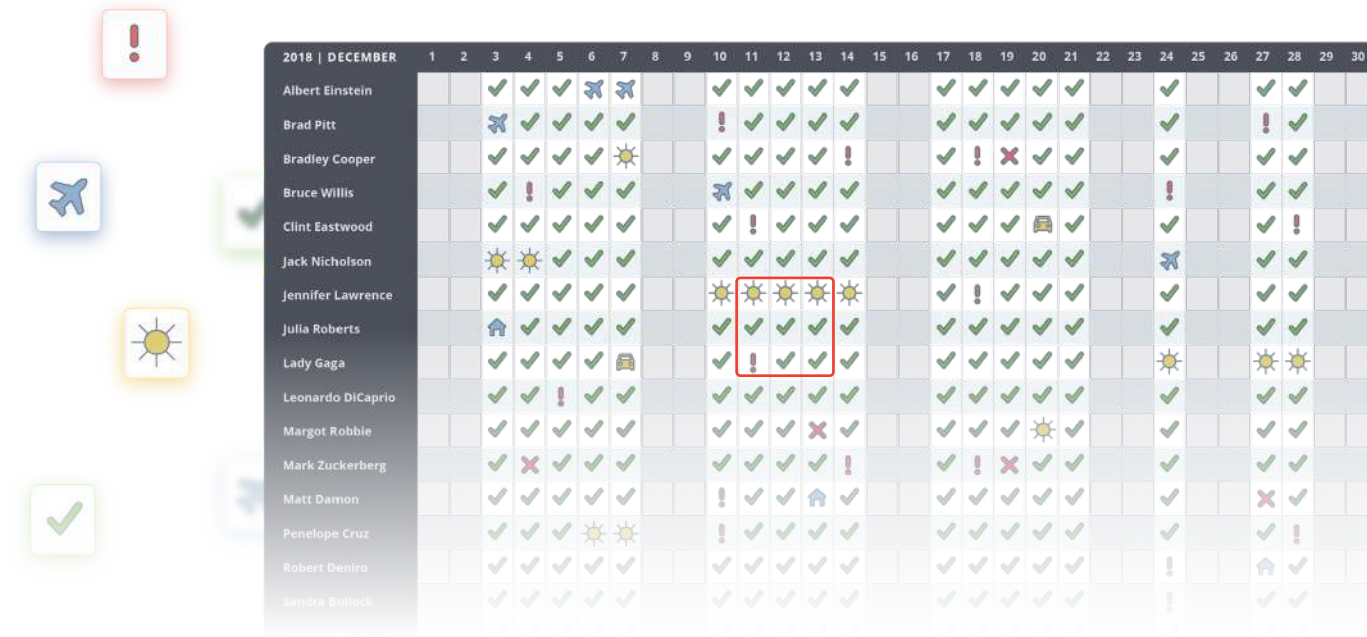

### Users' daily activities

Each employee's daily activity is displayed on color coded time bars, making delays, other violations, unpaid activities, breaks and overtime immediately visible.



## Daily activity report

This report displays detailed information about the employee's daily activities. The work time data can be also edited as necessary. The edited data can be restored at any time. Manually overridden data is highlighted by the system.

The screenshot shows the 'Daily activity report' for Adam Powell on Friday, 2026.03.13. It is divided into three numbered sections:

- 1 DAILY TIMELINE:** A horizontal bar chart showing 'Accepted' (green) and 'Raw' (grey) data points across the day.
- 2 CALCULATED WORKING TIME DATA:** A table comparing 'RAW' and 'ACCEPTED' data for various categories:
 

Category	RAW	ACCEPTED
Attendance	08:09	08:09
Arrival	08:34	8:34
Leave	16:43	16:43
Arrival to Leave	08:09	08:09
Attendance	08:09	8:09
Total worktime	06:49	06:00
Normal worktime	06:49	6:00
Overtime 50%	-	0:00
Overtime 100%	-	0:00
Unaccounted activity	00:50	1:10
Overtime starts	-	Not enough work
- 3 DAILY ACTIVITIES:** A list of activities with columns for TIME, CATEGORY, and ACTIVITY.
 

TIME	CATEGORY	ACTIVITY
08:34:23	Worktime	Work (1)
10:03:59	Unaccounted activity	Smoke break (5)
10:15:32	Worktime	External work (4)
13:59:00	Unaccounted activity	Lunch (3)
14:23:57	Worktime	Work (1)
15:30:00	Fix break	Work (1)
16:00:00	Unaccounted activity	Work (1)
16:03:06	Unaccounted activity	Smoke break (5)
16:16:25	Unaccounted activity	External work (4)
16:43:09	(not set)	Leave (2)

## Detailed reports

The system can generate a wide variety of freely configurable and modifiable reports, which can also be exported as Excel spreadsheets. These reports can list and summarize any work time data and irregularities.

Most of the data in the detailed reports can be edited manually if it is inaccurate due to employee negligence.

The reports can be saved as a template, so you can retrieve them later with a single click – always for the current period.

DATE	(ACCEPTED) ARRIVAL	(ACCEPTED) LEAVE	(ACCEPTED) ATTENDANCE	(ACCEPTED) WORKTIME	(R LA)
2026.01.01. (Thursday)	08:03	16:05	08:02	07:27	00:03
2026.01.02. (Friday)	07:56	16:01	08:05	07:34	-
2026.01.03. (Saturday (Rest day))					
2026.01.04. (Sunday (Rest day))					
2026.01.05. (Monday)	08:07	16:14	08:07	07:23	00:08
2026.01.06. (Tuesday)	07:56	16:03	08:07	07:34	-
2026.01.07. (Wednesday)	07:59	16:00	08:01	07:31	-
2026.01.08. (Thursday)	07:51	16:24	08:33	07:39	-
2026.01.09. (Friday)	08:13	16:00	07:47	07:17	00:13
2026.01.10. (Saturday (Rest day))					
2026.01.11. (Sunday (Rest day))					
2026.01.12. (Monday)	08:01	16:13	08:12	07:29	00:01
2026.01.13. (Tuesday)	08:00	16:02	08:02	07:30	-
2026.01.14. (Wednesday)	08:00	16:00	08:00	07:30	-
2026.01.15. (Thursday)	07:56	16:05	08:09	07:34	-
2026.01.16. (Friday)	08:05	16:09	08:04	07:25	00:05
2026.01.17. (Saturday (Rest day))					
2026.01.18. (Sunday (Rest day))					



## Shift scheduling, absence management

### Easy absence management

The work shift calendar interface displays a summary of schedules and absence, making it easy to plan shifts. Managers can modify shift schedules in groups or even grant time off to entire departments for any period of time. Thanks to automatic shift recognition, it is not necessary to determine the shift schedule in advance. The system assigns employees to shifts using an automatic matching algorithm based on movement data.

### Shift assignments

Registering and requesting time off is quick and convenient. Employee leave allowances can be imported from Excel spreadsheets. Annual allowances and off days taken can also be exported as Excel spreadsheets. Employees can also request absence via the web interface, which is then to be approved by the head of the relevant department.

### Work time web

#### Main functions:

- Employees can only see their own work time data
- Request time off
- Register remote work from anywhere, even with their mobile phones
- Managers can only see the data of their own employees, and can even assign them to shifts
- Managers can review their employees' leave requests and remote work registrations

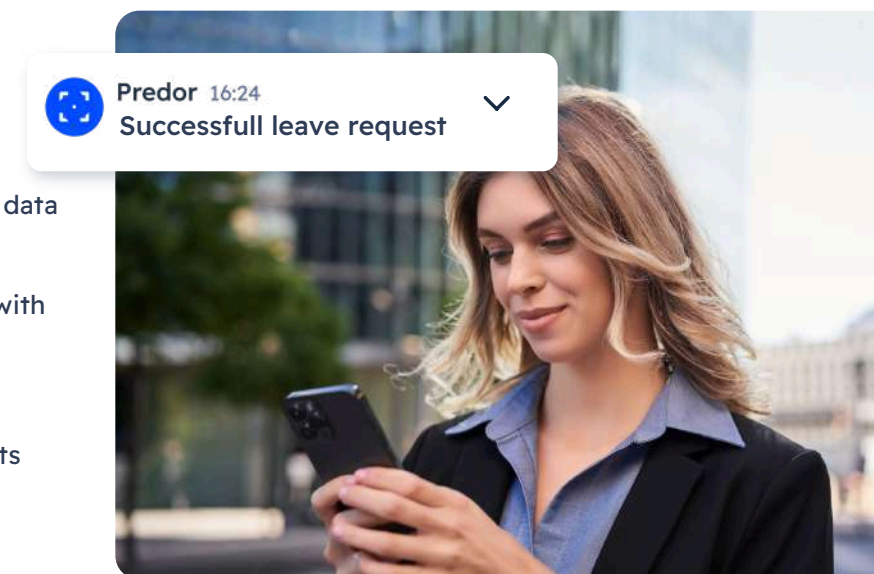

1 DAILY TIMELINE

2 CALCULATED WORKING TIME DATA

3 DAILY ACTIVITIES

## Graphical monthly summary report

Any installed card reader can be used as a work time terminal. The system continuously records how much time employees spent in each working area.

This report provides a breakdown of the composition your employees spent their working hours on.

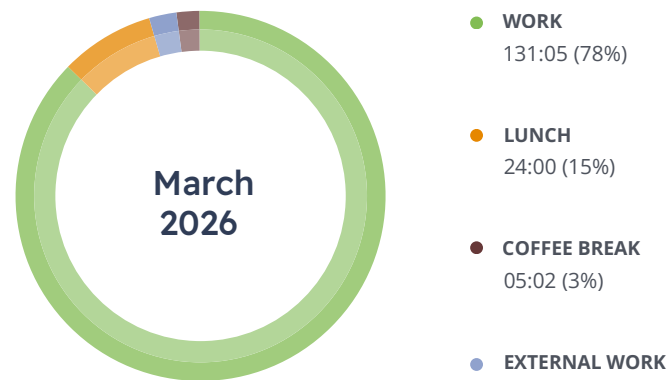

## Attendance sheet

You can select which columns to appear on the attendance sheet as you wish and also customize the data displayed on it. The system generates a signable PDF attendance sheet which can also be sent automatically via email.



## Work schedules

Fixed, hourly wages, three shifts and flexible work schedules are built-in and easy to manage, but you can also create custom work schedules with a unique set of rules. The program manages shift allowance periods, overtime, rolled-over balances, and complex break management.

Work schedules are called work time profiles in the Predor system, and up to 255 different, unique sets of rules can be created from them. A graphical display helps while editing time intervals.

### ACCEPTED TIME

Work performed outside the specified time interval is considered "unaccounted work." (most useful in the case of flexible work schedules)

### WORKING TIME

Indicates normal working hours. Working hours can be rounded arbitrarily. Automated measures can be taken in the event of late arrival, early departure, or core time violations. The minimum and maximum daily working hours can also be specified.

### CORE TIME

During core time, the employee is required to be present continuously, i.e., work may only be interrupted by permitted break.

## References

The Predor integrated access control and time and attendance system is widely used by small, medium and large enterprises. Its reliability, innovative features, modern software interface and flexibility make it suitable for a wide range of applications. The largest Predor installations support more than 8000 users.



# Become a Predor partner

**Predor Systems Ltd.**

[management@predorsystems.com](mailto:management@predorsystems.com)

---



[predorsystems.com](http://predorsystems.com)